

Development timeline

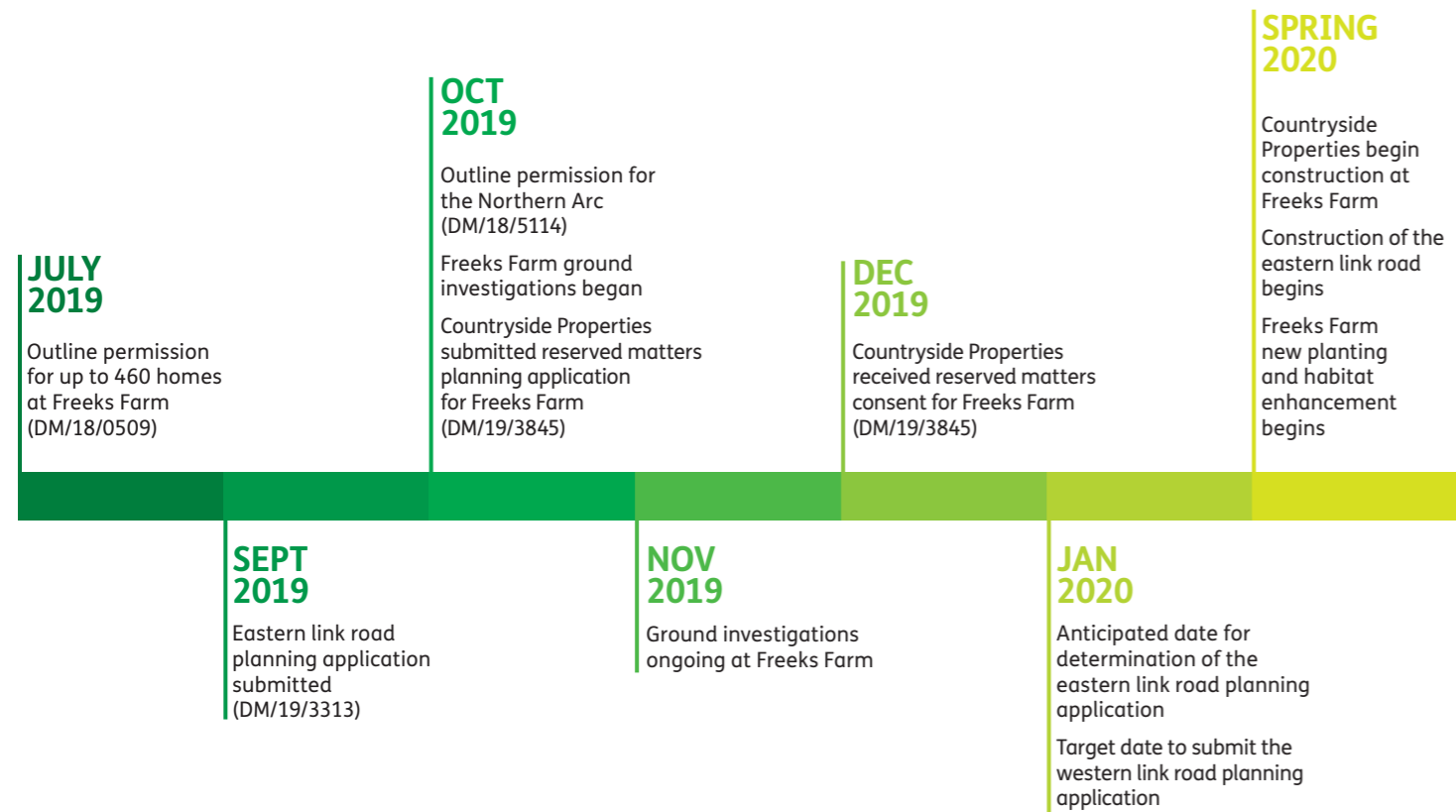

Get in touch

northernarc@aecom.com
Sarah Ward on 07776 527 643
www.burgesshill.net

Please come along to the first of our quarterly drop-in sessions which will be held on **Tuesday 28 January between 12 and 2pm at The Triangle, Triangle Way, Burgess Hill, RH15 8WA.** This is an opportunity for us to provide an update on progress and answer any questions you may have.



Homes
England



Northern Arc Update

January 2020



This is the first in a series of quarterly newsletters from Homes England to provide an update on the progress of delivery of the Northern Arc, Burgess Hill.

Development at the Northern Arc is part of the ambitious **Burgess Hill Strategic Growth Programme** which will transform the local economy by creating thousands of new jobs and homes.

The Northern Arc has been carefully designed to enable modern living within an environmentally sustainable community. In total, it will deliver up to **3,500 new homes (30% affordable)**, surrounded by approximately 80 hectares of **parklands and open spaces**.

New community and leisure facilities, primary and secondary schools and employment opportunities will provide the vibrant focal points of day-to-day living. These will be connected by **pedestrian and cycle networks**, easy access to **public transport** and **electric charging points** to promote a low carbon energy neighbourhood.

Over the next three years, Homes England expects to invest around **£41 million** in new pieces of vital infrastructure (a primary and a secondary school, roads, open spaces and neighbourhood centres). This infrastructure will enable the building of much needed new homes in Mid Sussex and ensure they are a real benefit to the local community by relieving traffic pressure and providing connections into Burgess Hill and the surrounding area.

Phase one of this multi-million-pound flagship development will be delivered between **2020 and 2025**. More information is available overleaf.

Phase one: 2020-2025

Community

A primary and a secondary school, two neighbourhood centres and a centre for outdoor sport

Open Space

Approximately 80 hectares of parklands and open spaces

Homes

1,000 new homes

Connectivity

Connecting Freeks Farm on the east to the A2300 and Jane Murray Way on the west

Employment

4 hectares of employment land

Sustainability

Pedestrian and cycle networks, public transport, electric charging points and low carbon energy

Biodiversity

Retaining and enhancing habitats and creating new ones

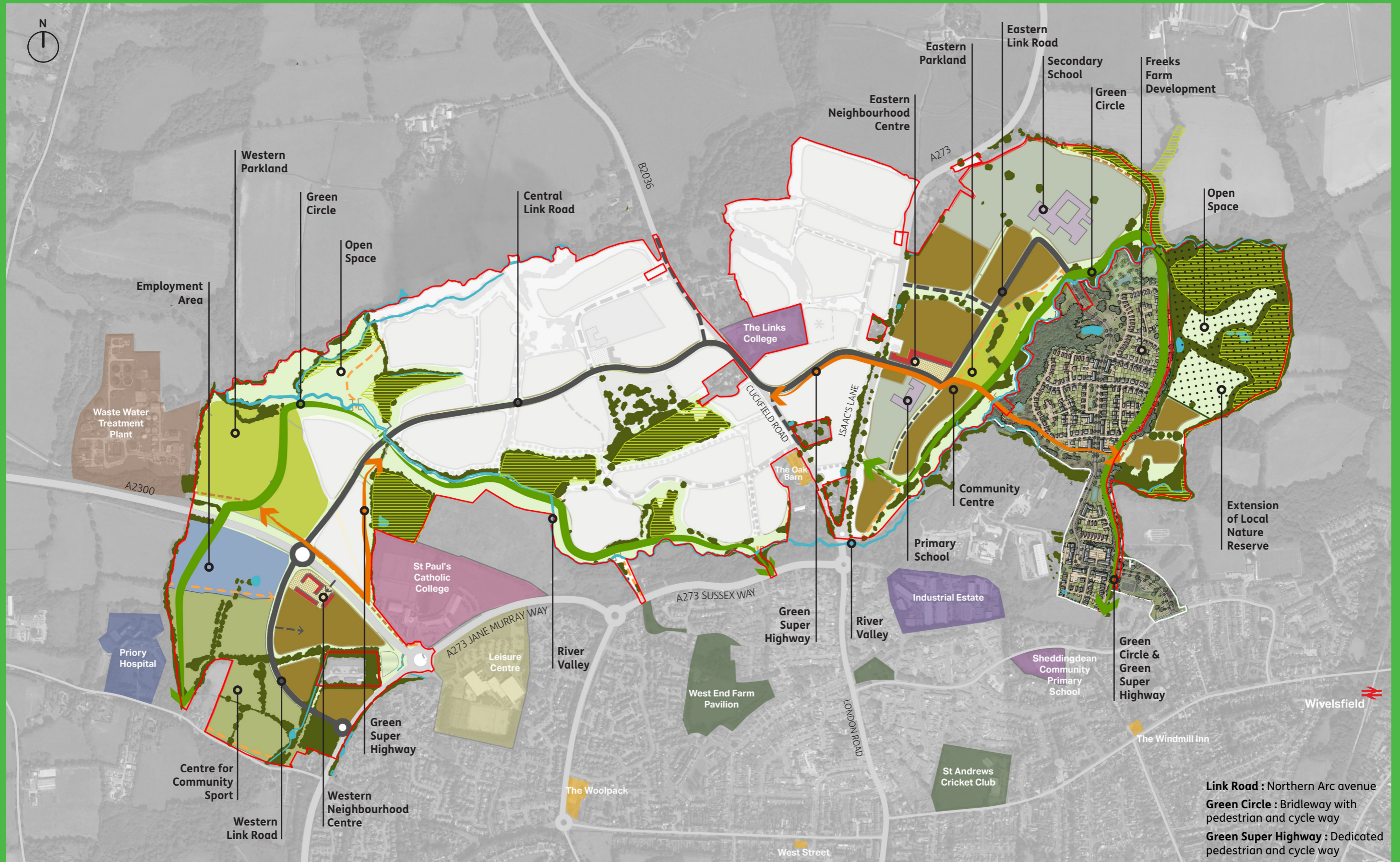

Phase one 2020 - 2025
Northern Arc Masterplan

| | | | | |
|------------------|----------------------------|-----------------------------------|-------------------------------------------|---------------------|
| Site boundary | Ancient woodland (hatched) | Centre for outdoor sport | Indicative layout of neighbourhood centre | Green circle |
| Residential area | Woodland | Open space | Link road | Green super highway |
| Employment area | Parkland | Extension of local nature reserve | Cycle and pedestrian route | Schools |